

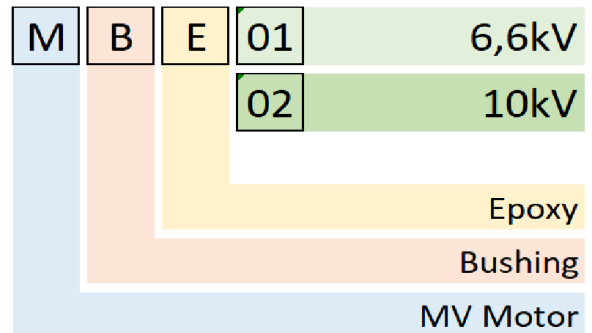

MBE-01/02

MV Motor Bushings

Aisladores de Motor MT



Raw material	Aromatic epoxy resin, hardened with dicarboxylic acid anhydrides filled with silanised silica	
Tensile strength	ISO R 527	79,28 N/mm ²
Flexural strength	ISO R 178	102,45 N/mm ²
Impact strength	ISO 179	9,2 kJ/m ²
Noth impact strength	ISO 179	1,2 kJ/m ²
Compressive Strength	ISO R 604	130 - 150 N/mm ²
Critical stress intensity factor (K _{ic})	CG 216-0/89	1.9 - 2.1 Mpa.m ^{1/2}
Specific energy at break (G _{ic})	CG 216-0/89	300 - 340 J/m ²
Glass transition point	ISO 11357-1 (DSC)	115 +5/-10 °C
Class of flammability	UL 94	V1 >12mm
Water absorbtion	ISO 62	0,018% by wt.
Coeff. of linear thermal expansion	DIN 53752 (20 - 80°C)	31-36*10-6 K-1
Tracking resistance	IEC 60112	CTI >600 -0.0
Dielectric constant	DIN 53483	4,2 (23 °C, 50 Hz)
Dissipation factor	IEC 60250	0,0309 % (23°C - 50 Hz)
Dielectric strength	IEC 60243 - 1	17 - 20 kV/mm
HV arc resistance	ASTM D 495	182 - 189 seconds
Density	ISO 1183-1	1.9 g/cm ³
Color		brown



SCM Chile Limitada

www.scmchile.cl

ventas@scmchile.cl

MBE-01

6,6kV

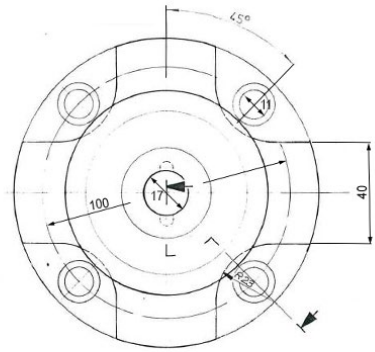
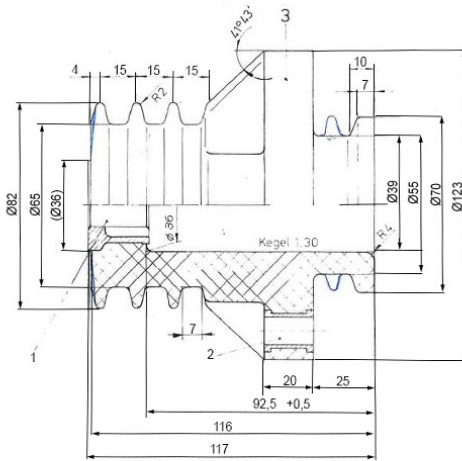

MBE-02

10kV

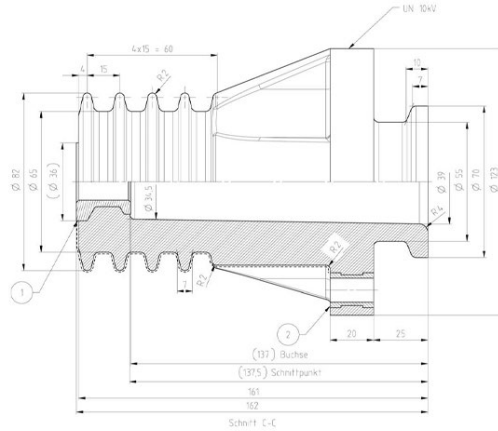

06/23